



IMPORTANT

Do not force the upper unit to close. Doing so may damage the scanner.

Cleaning the Roller Unit

- 1** Push the roller lock lever down. While supporting the roller unit with your hand, slide the roller lock lever to the right.

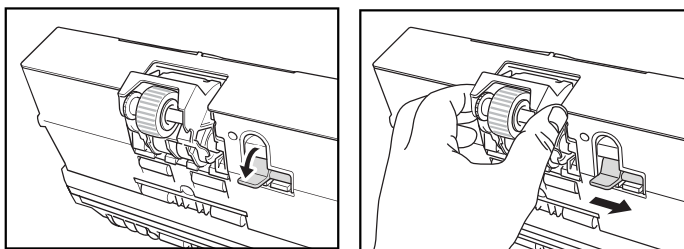

- 2** Move the roller unit to the right ① and then pull it out ②.

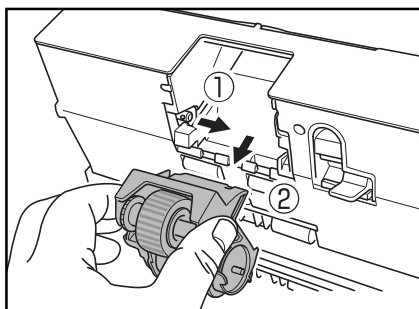

- 3** Wipe the removed rollers with a cloth that has been moistened with water and thoroughly wrung out.

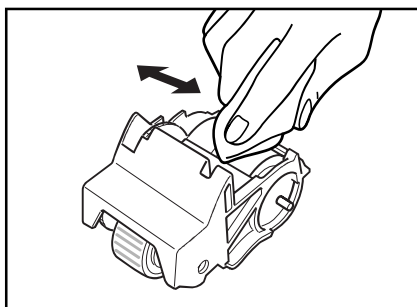

- 4** Align the cutout on the roller unit with the shaft pin on the main unit.

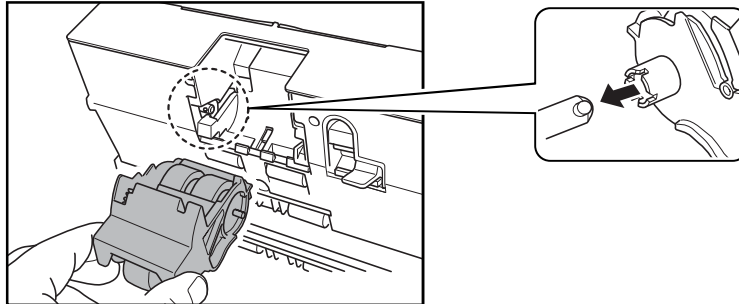

Note

If the cutout and pin do not fit, rotate the roller until the parts are properly matched.

- 5** Slide the roller lock lever to the left and raise the roller unit into position.

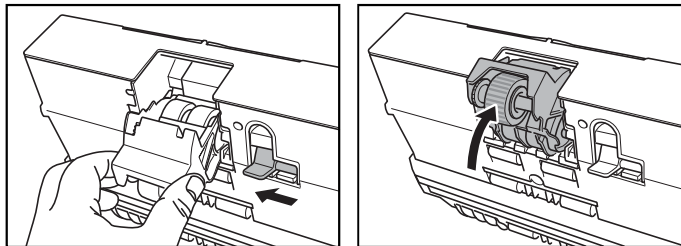

- 6** Push the roller lock lever up to lock the roller unit.

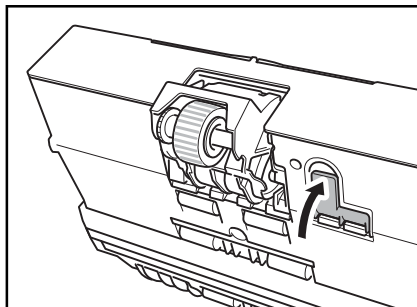

Cleaning the Retard Roller

- 1** Insert a finger of each hand into the grooves on both ends of the roller cover and remove the cover.

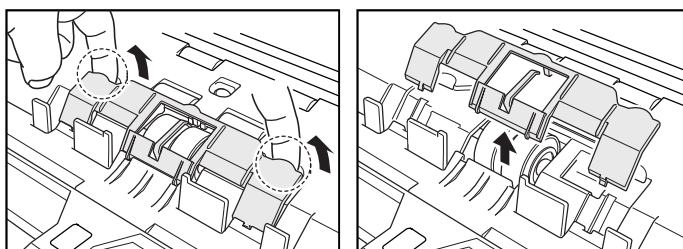

- 2** Move the roller lock lever down and forward (①,) and then slide it to the right (②.)

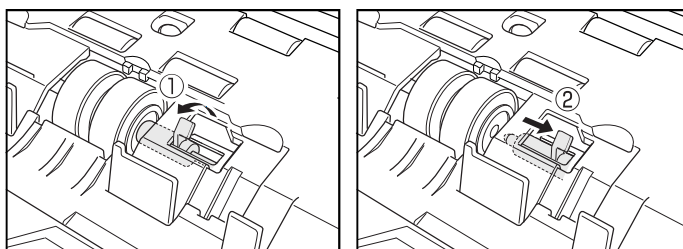

- 3** Shift the retard roller to the right to remove it.

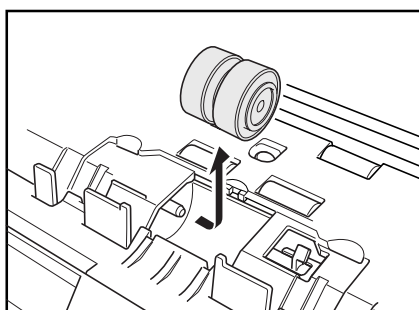

- 4** Wipe the removed retard roller with a cloth that has been moistened with water and thoroughly wrung out.

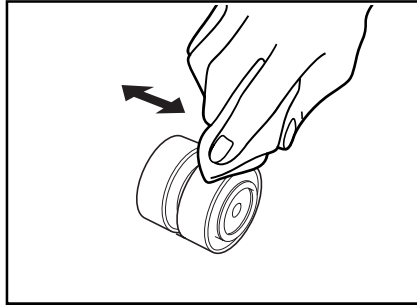

- 5** Position the retard roller so the notch in the roller is facing the scanner's shaft.

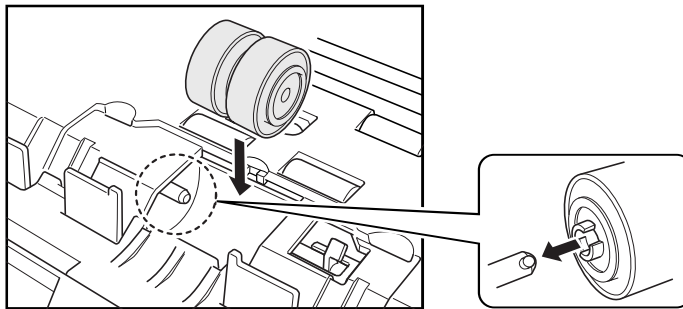

- 6** Slide the roller lock lever to the left, and insert it into the retard roller slot.

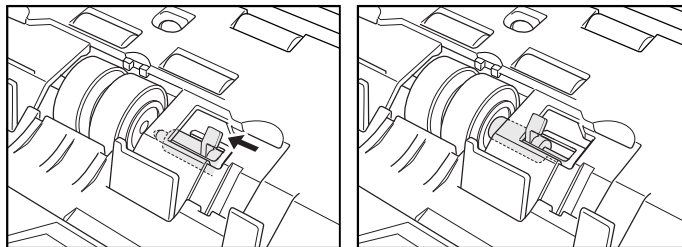

-
- 7** Push the roller lock lever towards the back of the scanner to lock the retard roller into place.

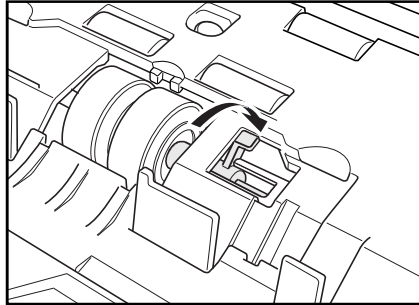

- 8** Replace the roller cover.

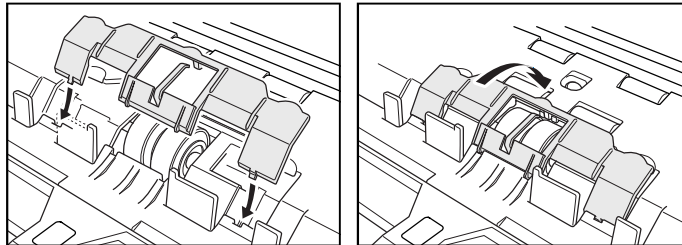

- 9** Push the center of the roller cover down and make sure that it clicks into place.

